

Plant valves

VG9000

DN15...100, PN6 and PN10

These flanged valves are primarily designed to regulate the flow of water and low pressure steam in response to the demand of a controller, in Heating, Ventilating and Air Conditioning (HVAC) systems.

Following electric actuators are available:

VA-7700 for DN15...50 valves

VA7810 for DN15...65 valves

VA1000 for DN65...100 valves.

Features

- ▶ Nodular cast iron body
- ▶ K_{VS} 0.63...160
- ▶ 2-way PDTO (normally closed) and 3-way mixing configurations
- ▶ Fluid temperature 2...140 °C
- ▶ DIN flanged

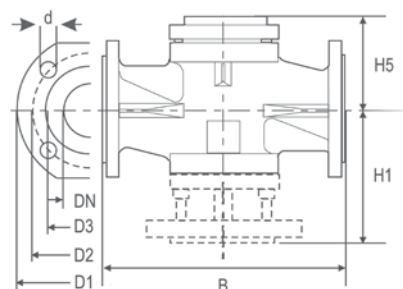

Dimensions in mm

Body Size	PN6							PN10						
	B	D1	D2	D3	d	H1	Holes	B	D1	D2	D3	d	H1	Holes
DN15	130	80	55	38	11	65	4	130	95	65	46	14	65	4
DN20	140	90	65	48	11	70	4	150	105	75	56	14	75	4
DN25	150	100	75	58	11	75	4	160	115	85	65	14	80	4
DN32	180	120	90	69	14	90	4	180	140	100	76	19	90	4
DN40	180	130	100	78	14	90	4	200	150	110	84	19	100	4
DN50	200	140	110	88	14	100	4	230	165	125	99	19	115	4
DN65	240	160	130	108	14	120	4	290	185	145	118	19	145	4
DN80	260	190	150	124	19	130	4	310	200	160	132	19	155	8
DN100	300	210	170	144	19	150	4	350	220	180	156	19	175	8

Plant Valves

VG9000
Ordering information
PN6 series (VG9xxxS1K)

Codes*	Body size	K _{VS}	Close-off pressure kPa					
			RA-3000-732x 3000 N	VA-1x20-GGA-1** 2000 N	VA-1125-GGA-1** 2500 N	VA-77xx-820x 500 N	VA78xx-xxx-12 1000 N	
2-way PDTO (Normally Closed) configuration								
VG94A5S1K	DN15	0.63	---	---	---	600	600	
VG94A4S1K		1.0						
VG94A3S1K		1.6						
VG94A2S1K		2.5						
VG94A1S1K		4.0						
VG94B1S1K	DN20	6.3	---	---	---	590	600	
VG94C1S1K	DN25	10						
VG94E2S1K	DN32	16						
VG94E1S1K	DN40	25						
VG94F1S1K	DN50	40						
VG94G1S1K	DN65	63	470	620	---	---	150	
VG94H1S1K	DN80	100	510	300			400	---
VG94J1S1K	DN100	160	320	180			240	---
3-way mixing configuration								
VG98A5S1K	DN15	0.63	---	---	---	600	600	
VG98A4S1K		1.0						
VG98A3S1K		1.6						
VG98A2S1K		2.5						
VG98A1S1K		4.0						
VG98B1S1K	DN20	6.3	---	---	---	490	600	
VG98C1S1K	DN25	10						
VG98E2S1K	DN32	16						
VG98E1S1K	DN40	25						
VG98F1S1K	DN50	40						
VG98G1S1K	DN65	63	470	620	---	---	130	
VG98H1S1K	DN80	100	510	300			400	---
VG98J1S1K	DN100	160	320	180			240	---

Notes

* For factory mounted valve actuators just add "+M" to the actuator ordering code.

** For fluid temperature >140 °C the extension kit VA1000-EP must be mounted.

Plant valves

VG9000
Ordering information
PN10 series (VG9xxxS1L)

Codes*	Body size	K _{VS}	Close-off pressure kPa					
			RA-3000-732x 3000 N	VA-1x20-GGA-1** 2000 N	VA-1125-GGA-1** 2500 N	VA-77xx-820x 500 N	VA78xx-xxx-12 1000 N	
2-way PDTO (Normally Closed) configuration								
VG94A5S1L	DN15	0.63	---	---	---	1000	1000	
VG94A4S1L		1.0						
VG94A3S1L		1.6						
VG94A2S1L		2.5						
VG94A1S1L		4.0						
VG94B1S1L	DN20	6.3	---	---	---	980	---	
VG94C1S1L	DN25	10				640		
VG94E2S1L	DN32	16				400		900
VG94E1S1L	DN40	25				210		510
VG94F1S1L	DN50	40				110		310
VG94G1S1L	DN65	63	510	470	620	---	160	
VG94H1S1L	DN80	100		300	400		---	
VG94J1S1L	DN100	160		320	180		240	---
3-way Mixing configuration								
VG98A5S1L	DN15	0.63	---	---	---	1000	1000	
VG98A4S1L		1.0						
VG98A3S1L		1.6						
VG98A2S1L		2.5						
VG98A1S1L		4.0						
VG98B1S1L	DN20	6.3	---	---	---	880	---	
VG98C1S1L	DN25	10				430		
VG98E2S1L	DN32	16				240		790
VG98E1S1L	DN40	25				110		420
VG98F1S1L	DN50	40				40		240
VG98G1S1L	DN65	63	510	470	620	---	120	
VG98H1S1L	DN80	100		300	400		---	
VG98J1S1L	DN100	160		320	180		240	---

Notes

* For factory mounted valve actuators just add "+M" to the actuator ordering code.

** For fluid temperature >140 °C the extension Lit VA1000-EP must be mounted.